

# PRODUCT SPECIFICATION

## METTRO 440

(Planter) 64440

The Metro planters enhance the beauty of your space and create a harmonious blend of contemporary and natural elements. The design features sophisticated metalwork with natural timber tops to create a sleek and warm visual appeal that will stand the test of time.

The Metro planters are carefully constructed using high-quality materials to ensure durability and longevity and are large enough to accommodate a variety of plants, from small flowers to larger shrubs. The possibilities are endless with these versatile and stylish planters.

### PRODUCT FEATURES

- Galvanised steel body
- Powder-coat finish
- Iroko slats
- Combine with other Metro range products
- Suitable for interior and exterior use
- 1 year manufacturer's warranty
- 4 week delivery (from approval/payment)

### ADDITIONAL OPTIONS

- Available in custom sizes
- Metal work available in any RAL colour
- Choose from a wide range of timber options
- Removable liner with lifting inserts

### INSTALLATION GUIDELINES

(These are guidelines only and do not replace, advice from qualified professionals)

-\***FREE STANDING** - Leave in place weighted to ground.

#### -\***BOLT DOWN - SURFACE FIX**

- 1) Excavate to given foundation dimensions (see data tables).
- 2) Fill with C40 grade concrete and level off, allowing sufficient space below ground to backfill (step 5) and leave to set.
- 3) Position the base plates as required on the concrete pad.
- 4) Base plates fixed to pad with M12 zinc plated anchor bolts.
- 5) Backfill to finished ground level with required materials.



### COLOUR OPTIONS

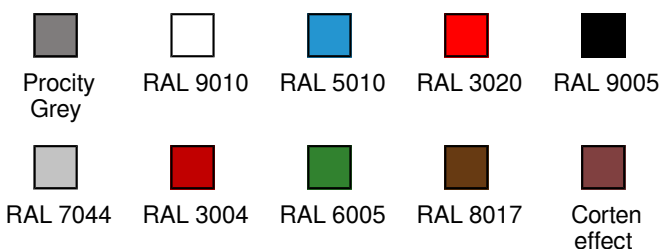

### PROJECT EXAMPLES

**HERTFORD** - The Bowls Club



### RELATED PRODUCTS

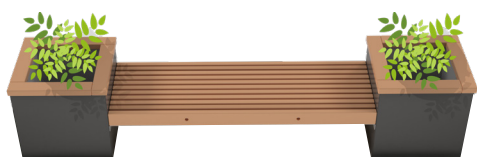

64110 METTRO 110 - Bench & Planter Combination



64111 METTRO 111 - Bench & Planter Combination

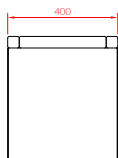
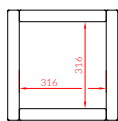
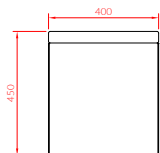

Product 64440.S04

Dimensions H 450 x W 400 x D 400mm

Capacity 28 Litre

Materials Powder-coated steel, Iroko

Bolt down foundations (per footing) *Concrete Pad*  
= 800 x 800 x 400mm deep  
*Concrete grade = C40*

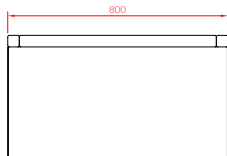
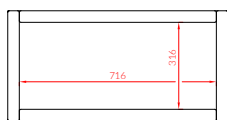
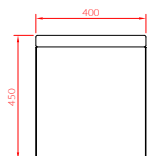

Product 64440.S08

Dimensions H 450 x W 800 x D 400mm

Capacity 62 Litre

Materials Powder-coated steel, Iroko

Bolt down foundations (per footing) *Concrete Pad*  
= 1200 x 800 x 400mm deep  
*Concrete grade = C40*

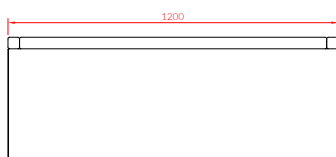
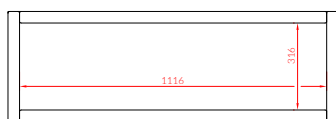
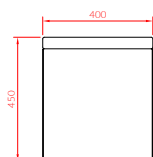

Product 64440.S12

Dimensions H 450 x W 1200 x D 400mm

Capacity 96 Litre

Materials Powder-coated steel, Iroko

Bolt down foundations (per footing) *Concrete Pad*  
= 1600 x 800 x 400mm deep  
*Concrete grade = C40*

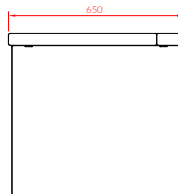
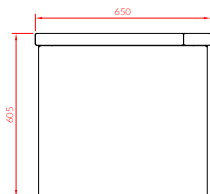
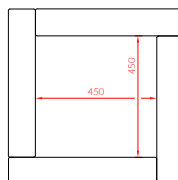

Product 64441.T04

Dimensions H 605 x W 650 x D 650mm

Capacity 64 Litre

Materials Powder-coated steel, Iroko

Bolt down foundations (per footing) Concrete Pad  
= 1050 x 1050 x 400mm deep  
Concrete grade = C40

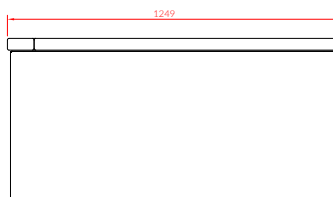
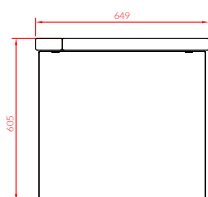
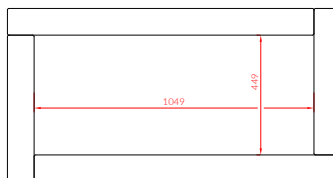

Product 64441.T12

Dimensions H 605 x W 400 x D 1250mm

Capacity 146 Litre

Materials Powder-coated steel, Iroko

Bolt down foundations (per footing) Concrete Pad  
= 1450 x 1050 x 400mm deep  
Concrete grade = C40