

Modular street furniture solutions.



Square Planter

Works in a run of benches or at the end. Use planters to create a sense of privacy or add colour.

Monolith

Promote your destination or sell space for advertising revenue.

Straight Bench

Joins to monoliths, planters and bench ends.

Triangular Planter

Works in a run of benches or at the end.

Cycle Stand

Attract additional visitors and create a pleasant rest area.

Bench End

Creates an open end to a bench, proving clear sightlines.

Components:	03no. 64015 Bench End
	+ 06no. 64030_18 Bench Slat 1800
	+ 04no. 64020 Square Planter
	+ 01no. 64022 Bench Triangle Planter
	+ 01no. 64001 Monolith
	+ 03no. 64040 Cycle Stands





Citi System® is a distillation of years of observation, listening, surveying, and thinking. It brings people together and provides comfort, conviviality, nature, and information all in one space.

Guy Walton

Guy Walton, Founder

6 of the key reasons to choose Citi-System®

1. Reduce clutter by combining multiple items into a single system
2. Sell advertising space to create a focal point and increase revenue
3. Create a perfectly coordinated space using items from a single supplier
4. Simpler installation with fewer ground fixings
5. Modular system enabling expansion and change
6. Designed and manufactured in the UK

Contents.

- 3 Introduction
- 4-11 Components
- 9-11 Components
- 12-13 Sustainability & ROI
- 14-16 Installation
- 16 Be part of the journey

The new modular – it's a signage range, it's also a street furniture range, it's both combined into one seamless beautiful product range.

Citi System brings multiple items together to reduce clutter, reduce waste, enhance public places and provide an income stream for the client. The benches and planters attract visitors, while the space on the monolith can be used for wayfinding, or sold as advertising space.

Inspired by vision, created by design Citi-System® grew out of a desire to move away from the current fragmented approach to furniture. Landmark project managers had observed how signage, cycle stands, benches and other items were frequently purchased from different suppliers resulting in a cluttered and untidy appearance.

Careful research and development has brought this range to the market ready to transform cityscapes worldwide. Top quality sustainably sourced timbers along with powder coated steel create a striking statement for your special place.

Unique and customisable Citi-System® is a registered design and is infinitely variable. From a simple bench to a multiple run of shaped spaces and walkways it fits any environment and can be customised to suit your unique requirements.





Components.



Colour Options

All metal components are powder coated to standard RAL colours for a professional and durable finish.



Here's how it works

Citi-System is formed from just 5 key components which can be used together or on their own.

Monolith Freestanding or built on, this stylish product has opening door for easy panel change and for even more variation the doors can be full-height or split into two.

Bench The slats can be hardwood, softwood or even aluminium. They are supported either by the monolith, the bench-end or the planter.

Bench-end The single can be used at the end of a run of benches to provide an uncluttered and inviting look. The straight unit is for joining runs of benches together.

Planter This can be used on its own or joined to a bench. Planters are available in different sizes for even more modularity.

Cycle stand Freestanding and fully coordinated they are equally at home on their own or with the system.

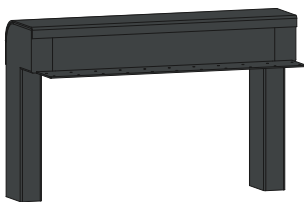

Model No: 64015 **Bench End**
OA Dimensions: 2200x725x220



Model No: 64016_180 **Bench Joiner 180°**
OA Dimensions: 400x625x270

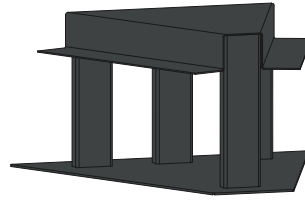

Model No: 64016_60 **Bench Joiner 60°**
OA Dimensions: 2200x725x220

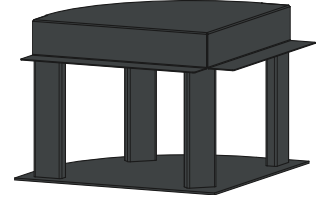

Model No: 64016_90 **Bench Joiner 90°**
OA Dimensions: 2200x725x220

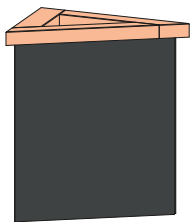

Model No: 64022 **Triangular Planter**
OA Dimensions: 700x600x700

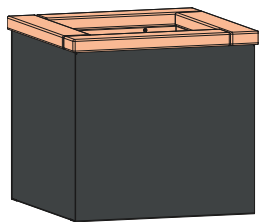

Model No: 64020 **Square Planter**
OA Dimensions: 650x650x605

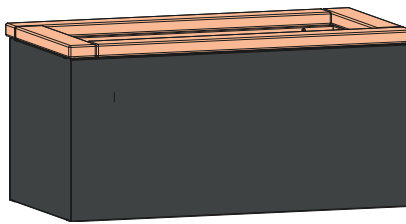

Model No: 64021 **Rectangular Planter**
OA Dimensions: 1225x650x605

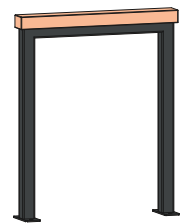

Model No: 64040 **Cycle Stand**
OA Dimensions: 650x150x800



Model No: 64001 **Monolith**
OA Dimensions: 2217x300x800

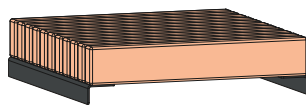

Model No: 64030_6 **Bench Slat 600**
OA Dimensions: 600x624x150

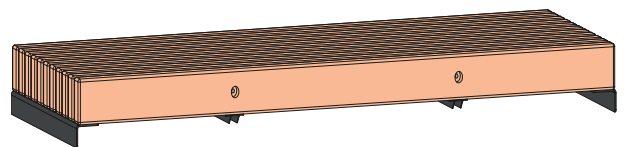

Model No: 64030_12 **Bench Slat 1200**
OA Dimensions: 1200x624x150

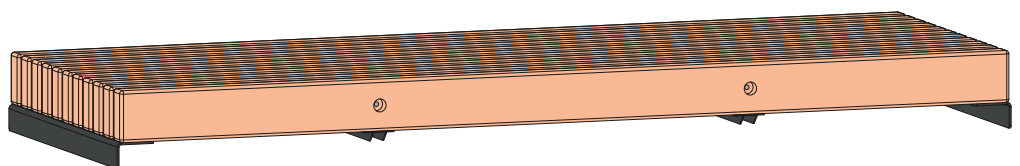

Model No: 64030_18 **Bench Slat 1800**
OA Dimensions: 1800x624x150

Endless Possibilities.

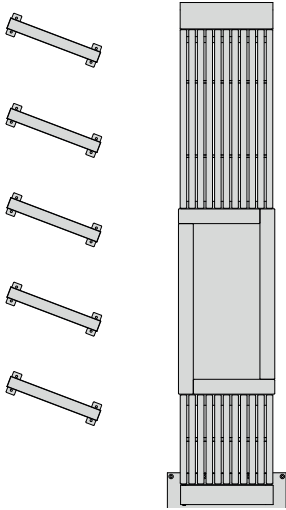

■ Seats up to 6

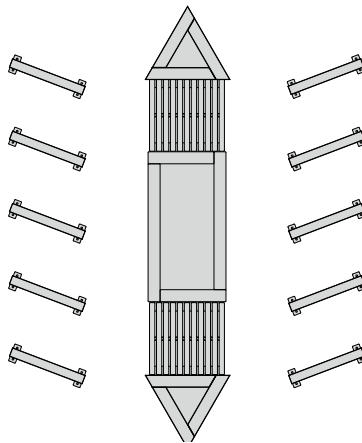

■ Seats up to 4

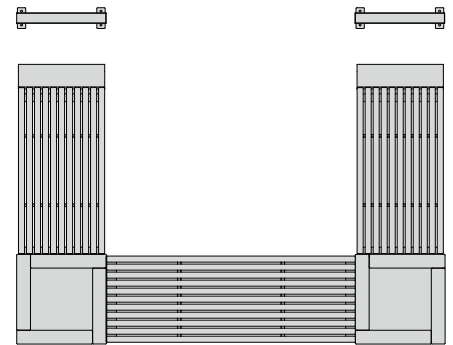

■ Seats up to 14

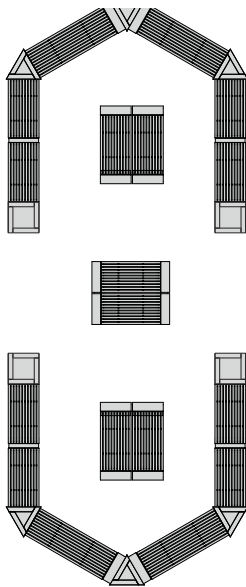

■ Seats up to 68

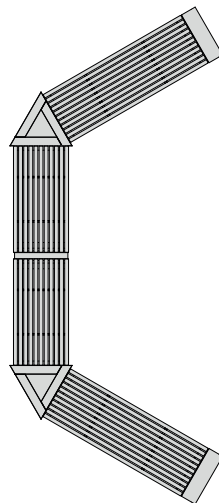

■ Seats up to 22

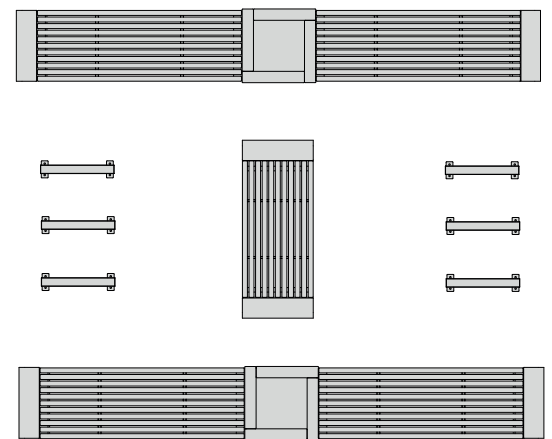

■ Seats up to 28

Your space. Your Design.



"From just a handful core components you can create an infinite variety of layouts using as many or as few as you wish..."

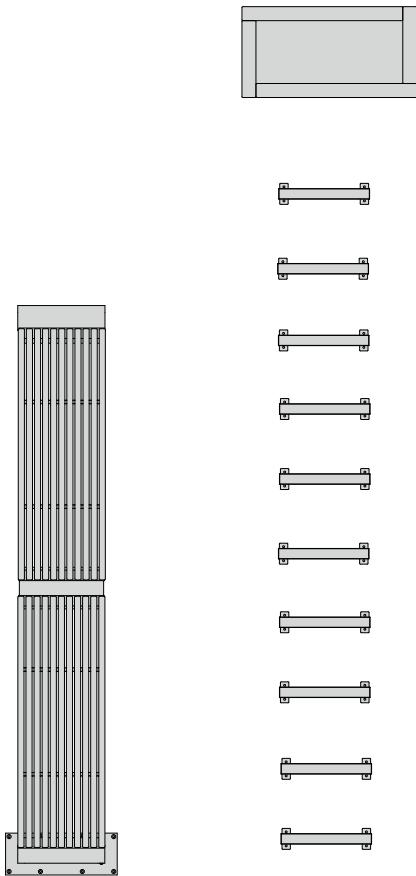

■ Seats up to 10

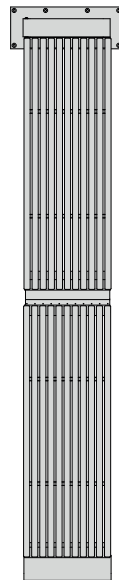

■ Seats up to 28

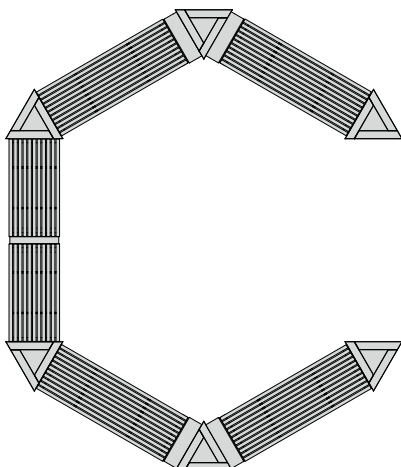
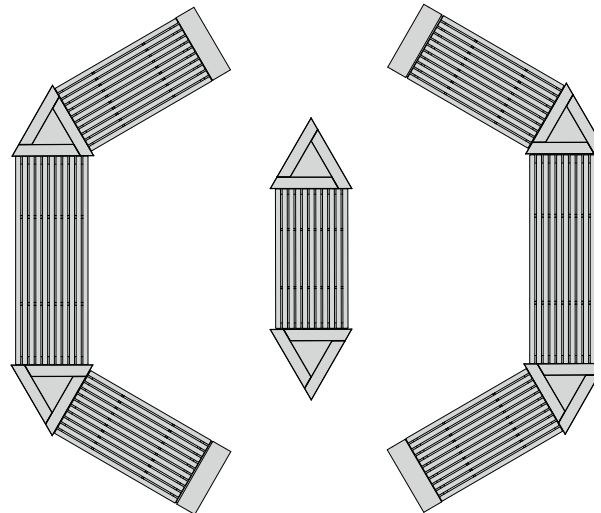

■ Seats up to 32

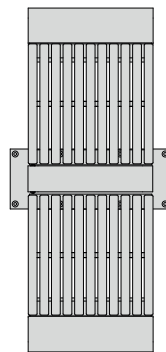

■ Seats up to 4

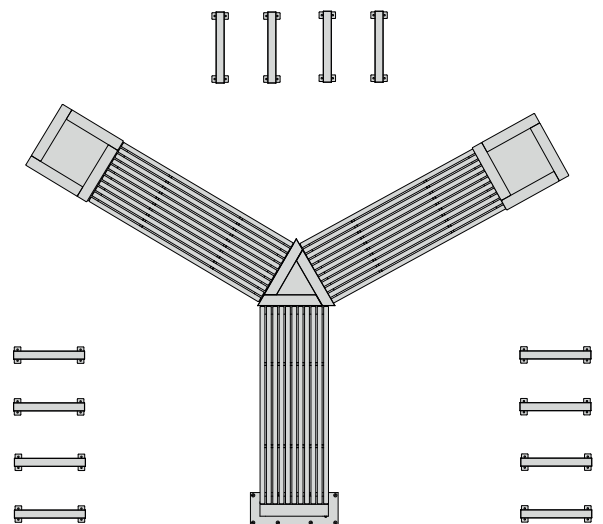

■ Seats up to 12



Modular System.



Seats up to: 6
Components: 02no. 64015 Bench End +
01no. 64010_18 Bench Slat 1800



Seats up to: 6
Components: 01no. 64015 Bench End +
01no. 64010_18 Bench Slat 1800 +
01no. 64020 Square Planter

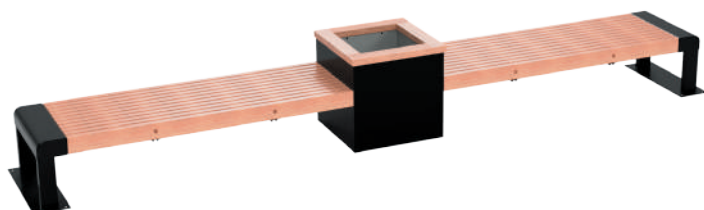

Seats up to: 12
Components: 2no. 64015 Bench End +
2no. 64010_18 Bench Slat 1800 +
1no. 64020 Square Planter





Seats up to:	20
Components:	03no. 64015 Bench End
	+
	03no. 64010_18 Bench Slat 1800
	+
	01no. 64020 Square Planter
	+
	01no. 64010_6 Bench Slat 600
	+
	01no. 64001 Monolith



Seats up to:	26
Components:	02no. 64015 Bench End
	+
	04no. 64010_18 Bench Slat 1800
	+
	02no. 64020 Square Planter
	+
	01no. 64010_6 Bench Slat 600
	+
	01no. 64001 Monolith
	+
	01no. 64016_90 Bench Joiner 90°



Seats up to:	40
Components:	03no. 64015 Bench End
	+
	06no. 64010_18 Bench Slat 1800
	+
	03no. 64020 Square Planter
	+
	02no. 64010_6 Bench Slat 600
	+
	01no. 64001 Monolith
	+
	01no. 64016_60 Bench Joiner 60°
	+
	01no. 64022 Bench Triangle Planter
	+
	02no. 64040 Cycle Stands

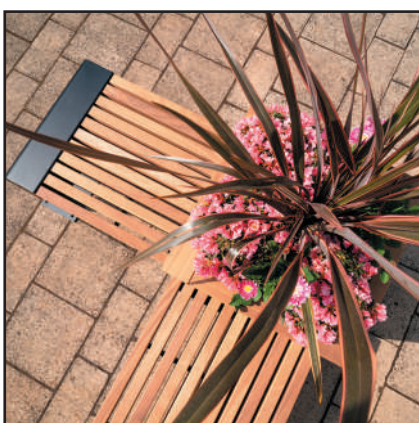

Welcome to Ringers Yard

Directory

01	Helmholtz	12	Jack Wills	23	The Hot Dog Co
02	Milly's Cafe	13	Waterstones	24	Anna's Crisps
03	Tompson	14	Jessops	25	Starbucks
04	New Look	15	Lucas Cofe	26	Fennell Designer Department Store
05	H&M	16	EE	27	Odeon Cinema
06	Super Dry	17	Hart Estate Agents	28	Zizzi
07	Paperchase	18	The Party Store	29	Prezzo
08	Recall & Sales	19	Shoe Zone	30	Be's
09	M&S Food	20	Town Library	31	Magamama
10	Ted Baker	21	Tesco Express	32	Five Guys
11	The White company	22	Mick's Key Cutting		



T: 0845 780 856

E: info@ringersyard.co.uk

www.ringersyard.co.uk



T: 0300 123 1384

E: info@hillington.gov.co.uk

www.hillingdon.gov.co.uk



The Monolith.

The monolith can be used as a stand-alone item, or built in to a larger system (or both if required). The standard format is a full-height door on one side and two half-height doors on the other. The doors swing open for ultra-quick and easy panel swap-over and the graphics panels are 3mm thick aluminium which can be supplied by us, or by the client. Graphics can contain promotional content, or the space can be rented out for additional advertising revenue.



Sustainability.



Inspired to Work Sustainably.

Sustainability is more than just recycling materials. Citi-System has been designed to maximise sustainability by actually reducing the number of excavations needed. For example the image on page 2 would need 20 foundations if each item was stand-alone in the traditional style but here it only requires 9 foundations.

The Circular Economy.

Citi System® embraces the concept of the Circular Economy. Great care has been taken to ensure minimal impact on the planet during manufacture, transport, installation, and maintenance.

1. Combining modular units reduces material, transport weight, and installation disruption, saving resources, fuel, time, and reducing wastage.
2. Components have multiple uses, creating manufacturing efficiencies and reducing stock-holding.
3. Units can be sold outright, rented, leased, and refurbished. Components not suitable for refurbishment can be recycled.
4. Raw materials are sourced from the most sustainable suppliers, using certified or reclaimed timbers and UK or European steel for all components.

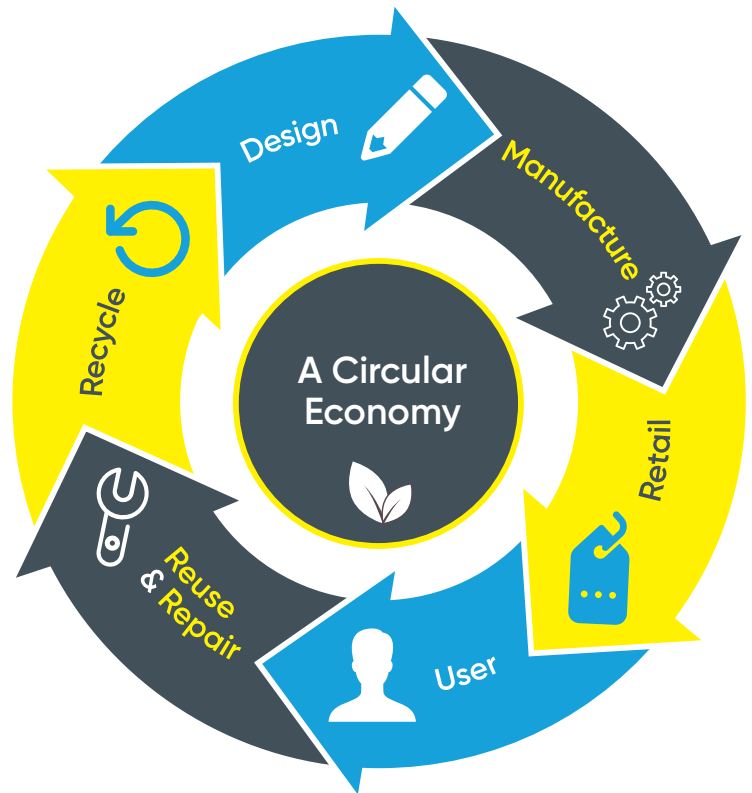

'The River Lea runs through the King's Meads Nature Reserve on the doorstep of the Landmark offices, providing a source of inspiration to look after our beautiful planet'.

GW



Installation.

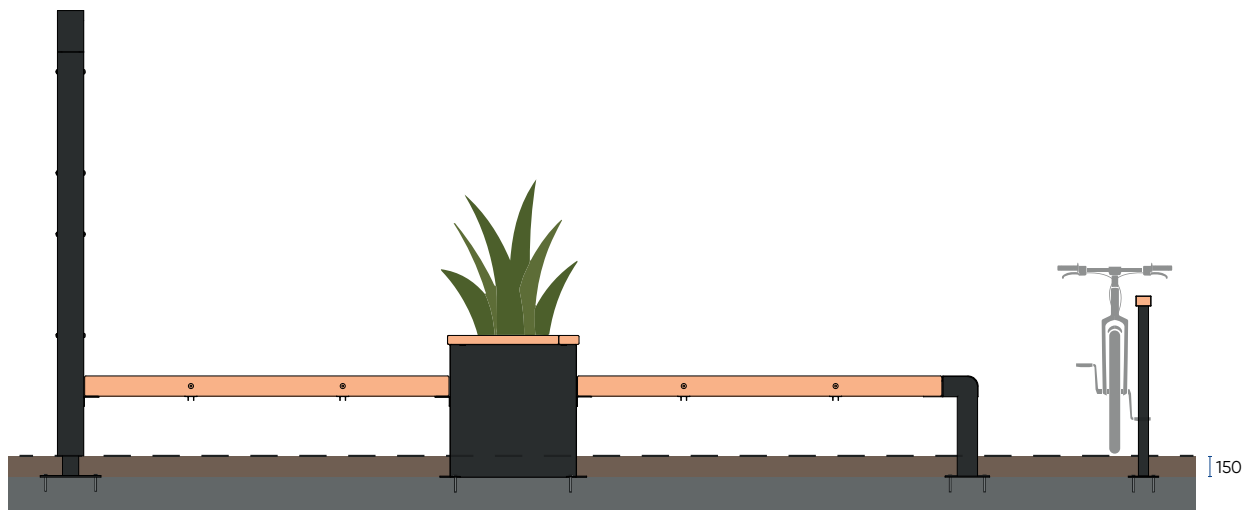

Bolt Down - Sub-surface

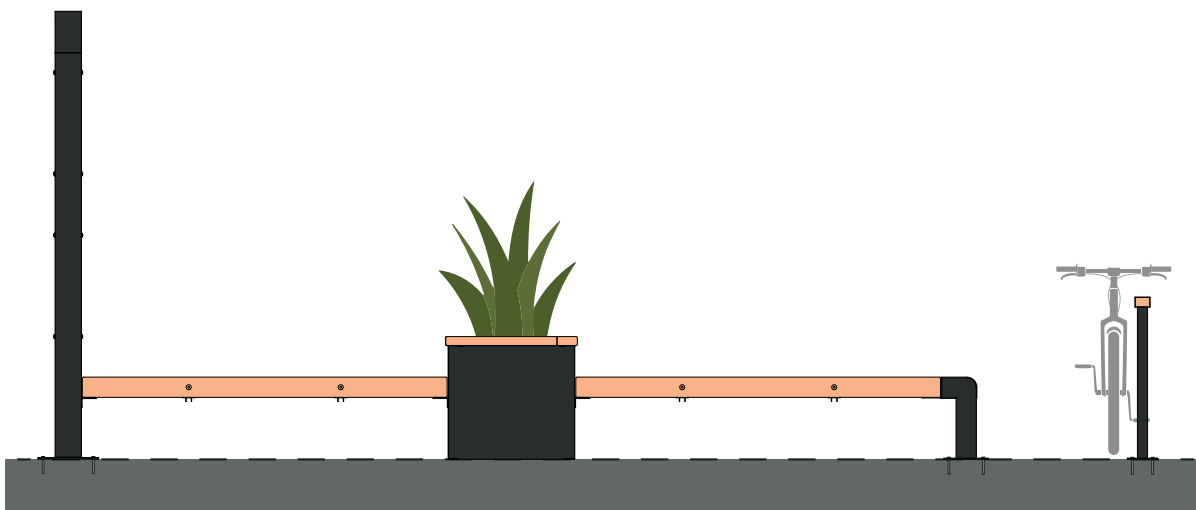

Bolt Down - Surface

Installation Notes.

These are guidelines only and do not replace advice from qualified professionals and relevant contractors.

Citi-System can be subsurface or surface mounted depending on ground conditions.

Sub-surface

Recommended for sloping and/or soft ground, all items are installed on concrete pads 150mm below Finished Floor Level using M12 bolts in pre-drilled baseplates

Surface

Suitable for flat and/or hard ground, all items can be bolted directly to a hard surface using M12 bolts in pre-drilled baseplates. Note that the baseplates are approximately 8mm thick. The monolith must always be installed on perfectly flat ground.

Be part of the journey.

You know your spaces and needs better than anyone, and we welcome your ideas and feedback. Let us know if you require a particular feature or component and share your ideas.

We're on a journey to help everyone appreciate and enjoy public spaces, whilst helping the planet, one component at a time.

©Hornbeck Ltd t/a Landmark. The Citi-System® name and logo are registered trademarks. The Citi-System® products are registered designs.